



Apartment 22 Lincoln Apartments 3 Lexington Gardens

Birmingham, B15 2DS

Offers Over £178,000





## Floor Plan

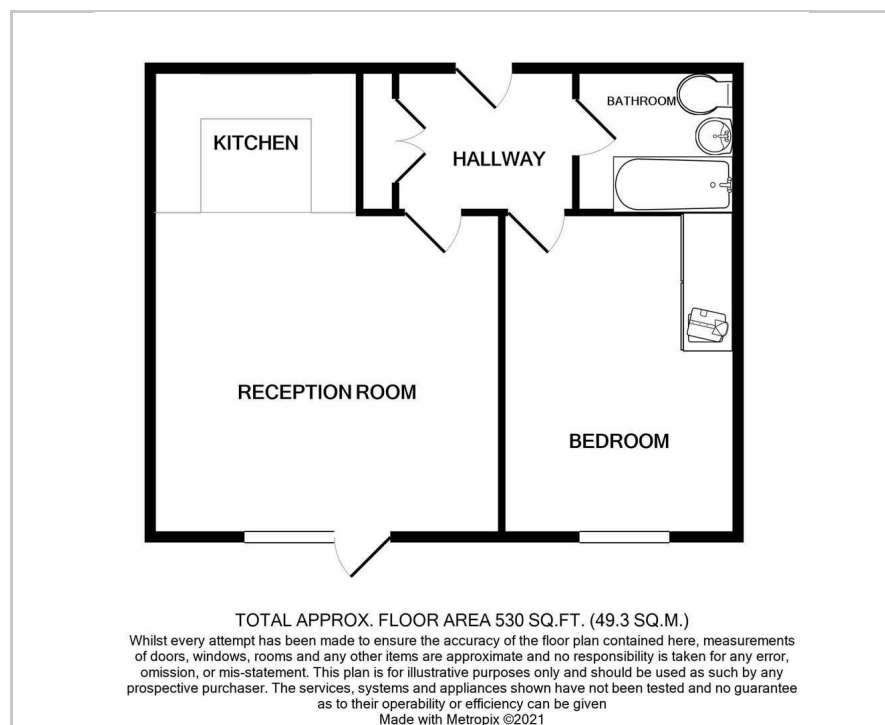

## Area Map



## Energy Efficiency Graph

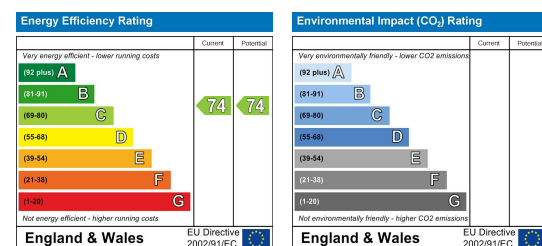

## Viewing

Please contact our LV PROPERTY Office on 01212857575 if you wish to arrange a viewing appointment for this property or require further information.

- STUNNING ONE ■ JULIETTE BALCONY WITH BEDROOM APARTMENT GARDEN VIEWS
- EWS1 FORM IN PLACE ■ SELLING CHAIN FREE
- GREAT INVESTMENT ■ PERMIT PARKING AVAILABLE

\*\*NEW BUILD IN THE CITY CENTRE\*\*

LV PROPERTY is proud to present a spacious, one-bedroom apartment placed within the SOLD OUT development of Lincoln Apartments, Lexington Garden in Birmingham City Centre. This development is purposely positioned for residents to be able to enjoy the uniqueness and individuality of the City's most popular zone, along with the close transport links that are within the heart of the iconic Birmingham Centre.

The property features an immaculately decorated one-bedroom apartment, with a built-in wardrobe, a fully integrated kitchen and a fully fitted family bathroom.

Birmingham has been named the most investable city in the UK for a second year running. With the major schemes such as HS2 and the Curzon Street regeneration, Birmingham is rapidly becoming one of the most sought after locations and set to be in the top ten best places to invest money on the continent.

Birmingham has been named the most investable city in the UK for a second year running. The city was named above the likes of Milan, London and Paris in an annual survey of European investors' intentions, which named it the sixth-best place to invest money on the continent.

These particulars, whilst believed to be accurate are set out as a general outline only for guidance and do not constitute any part of an offer or contract. Intending purchasers should not rely on them as statements of representation of fact, but must satisfy themselves by inspection or otherwise as to their accuracy. No person in this firm's employment has the authority to make or give any representation or warranty in respect of the property.



0121 285 7575  
www.lvproperty.co.uk

157c Warstone Lane, Jewellery Quarter,  
Birmingham, West Midlands, B18 6NZ